

Section A

Section B

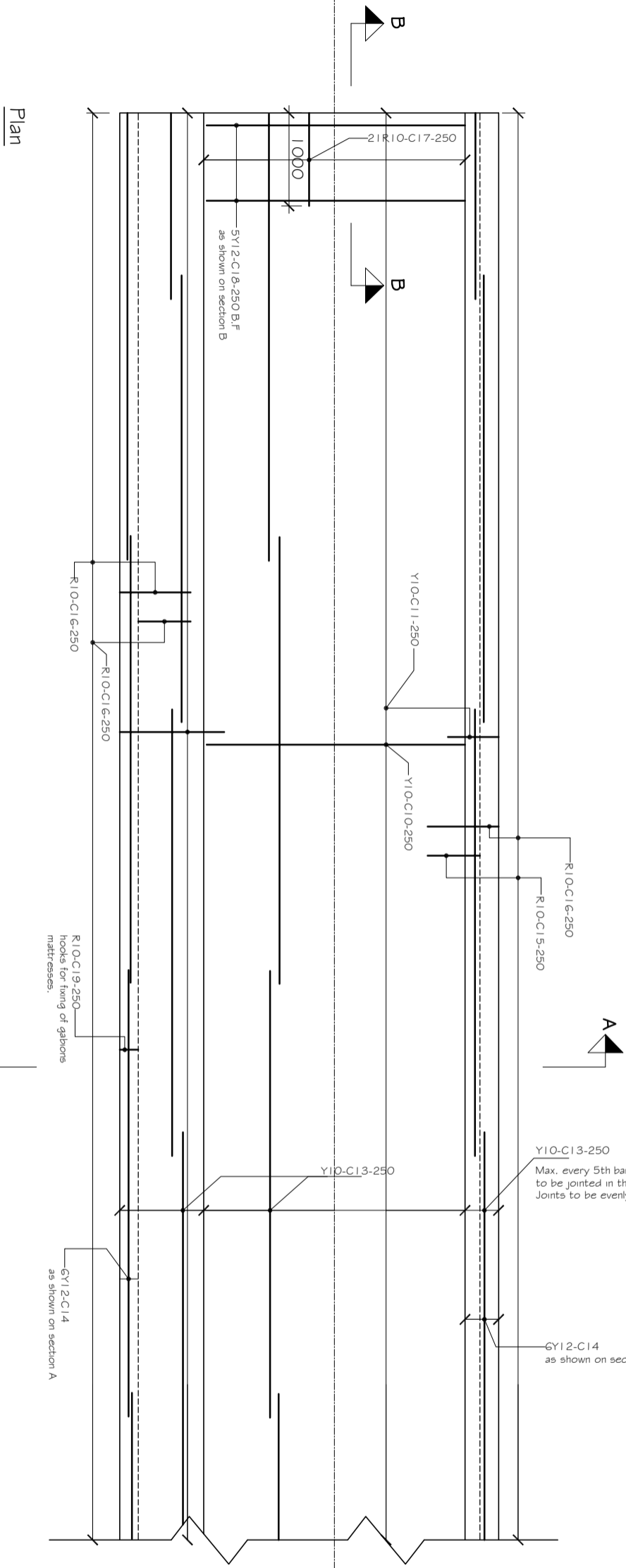

Plan

Y10-C13-250
Max. every 5th bar, C13 to be jointed in the same section. Joints to be evenly distributed.

GY12-C14 as shown on section A

GY12-C14 as shown on section A

R10-C19-250 hooks for fixing of gabions mattresses.

NOTES
1. General notes, see drawing L-101

| REV/NO | DATE | DESCRIPTION |
|--------|------|-------------|
| | | |
| | | |
| | | |
| | | |

CLIENT: COUNTY GOVERNMENT OF MAKUENI
INFRASTRUCTURE, TRANSPORT & PUBLIC WORKS
P.O BOX 78-90300
MAKUENI

PROJECT: DRIFTS
Reinforcement

CHIEF OFFICER (T/PM)
DIRECTOR (T/PM)
SENIOR SUPT ENGINEER (DESIGN)
SUPT ENGINEER (DESIGN)
PROJECT ENGINEER

SCALE: NTS
DESIGNED BY: D.S.M
DRAWN BY: D.S.M
CHECKED BY: SOA
DATE: JAN. 2024

Notes: